

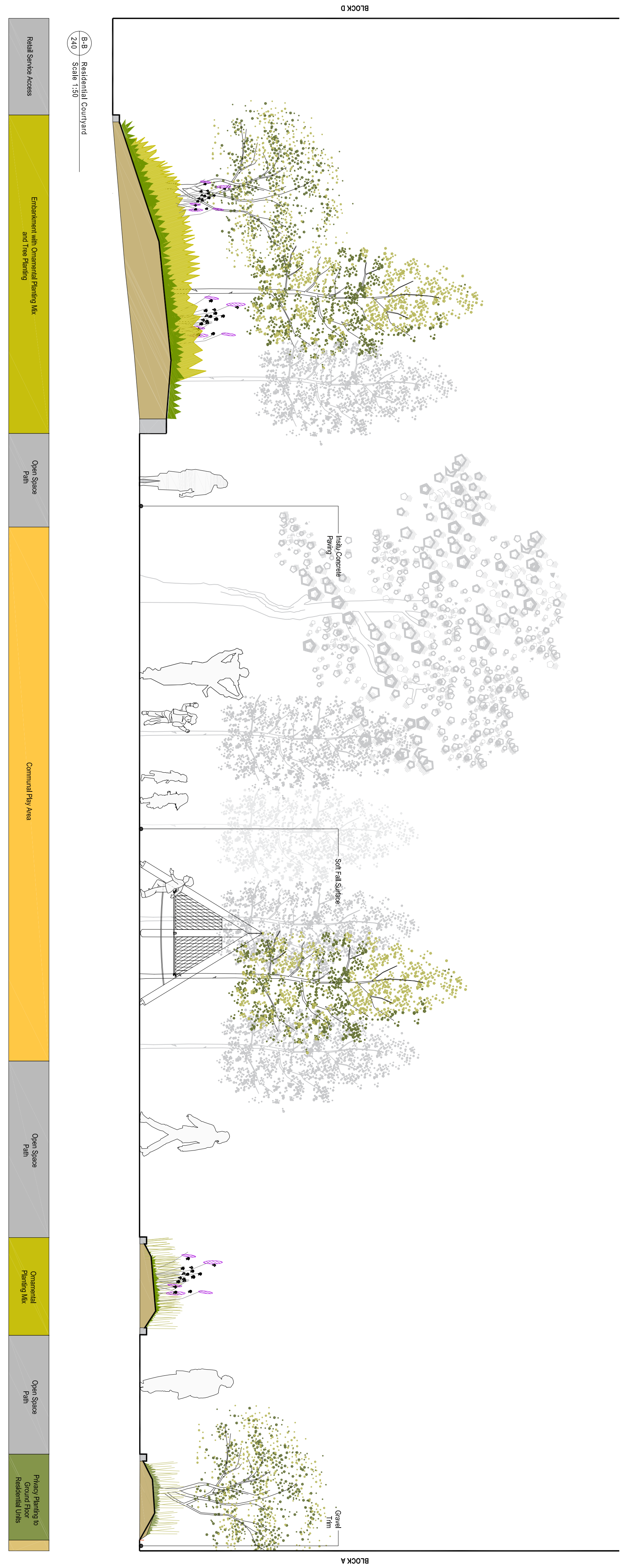

A-A District Centre Public Plaza  
240 Scale 1:50



B-B Residential Courtyard  
240 Scale 1:50

This drawing is the copyright of ait and no part of it may be reproduced, stored in a retrieval system, or transmitted in any form or by any means, electronic, mechanical, photocopying, recording, or by any information storage and retrieval system, without the prior written permission of ait. The landscape architect shall be responsible for the design of any structures shown on this drawing.

DATE	REV.	DESCRIPTION	BY	CHECKED

NOTES:

**ait**  
urbanism + landscape

CLIENT: Glenmeagh Living Ltd  
PROJECT: Koochamara District Centre, Rahon, Galway  
DRAWING: Landscapes Sections 1 of 2

30th Floor, Riverbank House  
Dublin 8, Ireland  
Tel: +353 1 232 2200  
www.ait.ie

**ISSUE STATUS:**  
PLANNING  
DRAWING NO: 18GY03-DR-240  
DATE: 28.10.2019  
PROJECT NO: 180103  
SCALE: 1:50  
SHEET NO: 1A  
SHEET SIZE: A1  
CHECKED BY: ND